

CLAIR ILLUMINATION LED DISPLAY

Vertical Stand Display

PRODUCT PARAMETERS	
Product Model	P1.86
Pixel Pitch	1.86mm
LED lamp	SMD1212
Cabinet pixel	344*1032
Module size(mm)	320*160*14mm
Cabinet size(mm)	640x480*60mm
Cabinet weight(kg)	35Kg
Brightness (nits/scan)	800-1000(43s)
Max power	800w
Maintenance	All front
Power input	100-240V AC 50-60Hz
Working humidity	-20~+60
Refresh rate (Hz)	7680Hz
IP rating	IP35
Signal input	HDMI



Size: 640 x 1920 x 60mm

Features:

- Wireless. Remote controlled by mobile phone. Play content from cloud
- Multiple stand displays can splice together
- Move freely with wheels with break
- Pixel Pitch: P1.86 / P2.5
- 4 cabinets spliced to 1 display
- High brightness 800-1000cd/m²
- High refresh rate : 3840Hz
- IP rate: IP35
- Front maintenance
- With USB

Features:

- Front maintenance, high refresh rate, built-in HUB board
- Power supply and signal dual backuo
- Indoor protection level IP35
- Small pixel pitch display suitable for 8K video

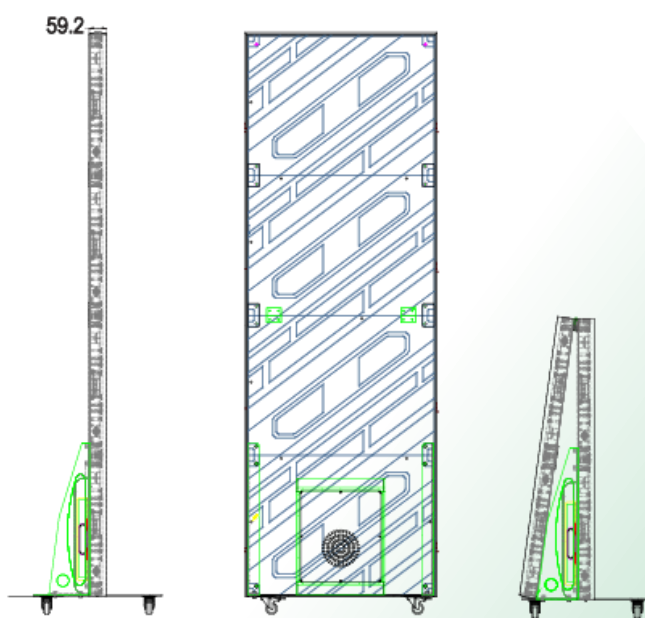
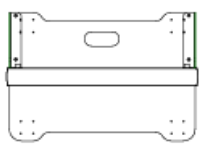
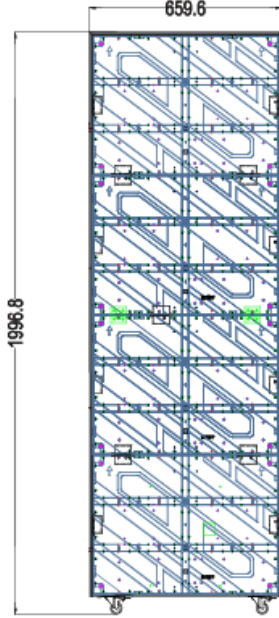
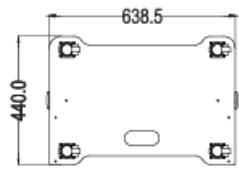

LED Panel weight:
51Kg

Flightcase weight:
35Kg

Flightcase dimension:
Depth: **80cm**
Height: **124cm**
Width: **54cm**